

1. Construction and dimensions

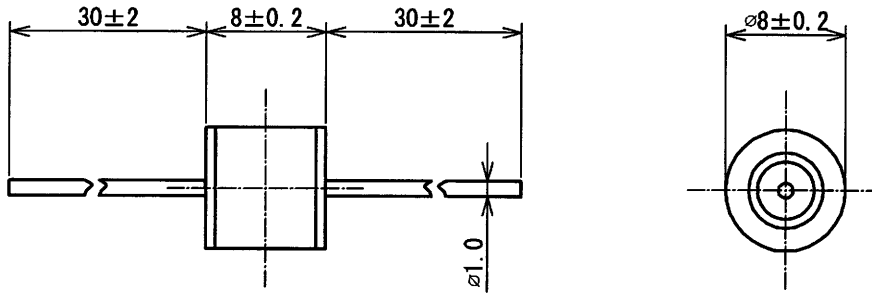

2. Marking

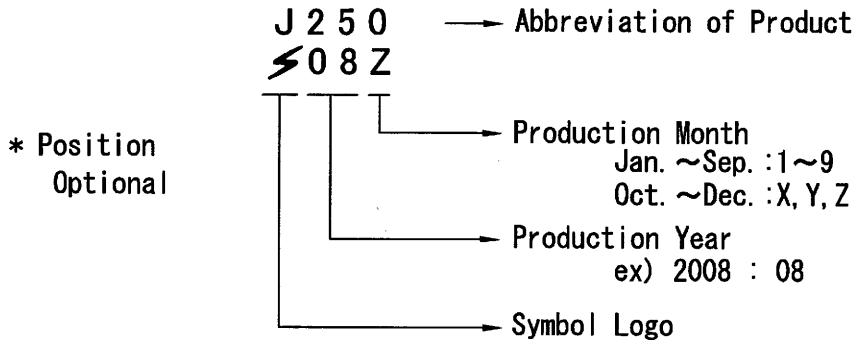

3. Electrical Characteristics

1. DC Spark-over Voltage	100V/s	250V ± 20%
2. Impulse Spark-over Voltage	1kV/μs	≥ 1,000V
3. Insulation Resistance	DC 100V	≥ 10,000MΩ
4. Capacitance	1MHz	≤ 1.5pF
5. DC Holdover Voltage	DC 52V, ITU-T K. 12 Test1	≤ 150ms
6. Impulse Life	10/1000 μs 100A	300times
7. Impulse Discharge Current	8/20 μs 15kA	+5, -5times
8. AC Discharge Current	50Hz, 20A 1sec	10times

After Test of Item 6, 7 and 8

1) DC Spark-over Voltage	100V/s	250V ± 30%
2) Impulse Spark-over Voltage	1kV/μs	≥ 1,200V
3) Insulation Resistance	DC 100V	≥ 100MΩ

DSN	S.E.D	Dec. 25. '08	UNIT	mm		TITLE	CERAMIC ARRESTER Y08J-250B
DWG	<i>S. Iwano</i>	Dec. 25. '08	SCALE	2/1		DWG No.	T-080780C01
CHK	<i>Y. Uwano</i>	Dec. 25. '08				REV.	